

LED PROJECTOR

LTL.PL3610IP25 / LTL.PL3610IP45

Operation manual



TABLE OF CONTENTS

1. Specifications.....	Page 3
2. Safety instructions.....	Page 3
3. Dimensions.....	Page 3
4. DMX control.....	Page 3
5. Exploded view.....	Page 4
6. Operation instructions.....	Page 5
7. Master / slave mode.....	Page 6
8. Signal cable connection.....	Page 6

1. SPECIFICATIONS

- AC 220 - 240V
- Max. power : 360W
- Lamp type : 10W power LED
- RGBW - 4 in 1 -
- DMX512, master / slave
- Channels : 3 - 4 - 5 - 8
- Effects : Dimmer, strobe, color changes
- Beam angle : LTL.PL3610IP25 25° / LTL.PL3610IP45 45°
- IP65
- Dimensions : 365 x 365 x 400 mm
- Weight : 12 kg

2. SAFETY INSTRUCTIONS

- Befor installation, be sure the projector has any damage, caused during the ride
- This projector is made for inside or outside use but the ambient temperature must not exceed 40 ° C
- Ensure that no flammable objects are near the projector (within 50cm)

3. DIMENSIONS

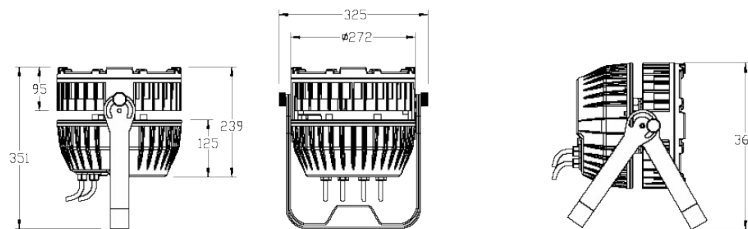

4. DMX CONTROL

- DMX HSI control mode (3 channels)

Channel	Value	Function
1	0-255	Mix RGB
2	0-255	White dimmer 0-100%
3	0-255	General dimmer 0-100%

- DMX RGBW Control mode (4 channels)

Channel	Value	Function
1	0-255	Red 0-100%
2	0-255	Green 0-100%
3	0-255	Blue 0-100%
4	0-255	White 0-100%

- DMX DRGBW Control mode (5 channels)

D = Dimming

Channel	Value	Function
1	0-255	General dimmer
2	0-255	Red 0-100%
3	0-255	Green 0-100%
4	0-255	Blue 0-100%
5	0-255	White 0-100%

- DMX DRGBWSMP Control mode (8 channels)

S = Strobe M = Macro P = Speed

Channel	Value	Function
1	0-255	General dimmer
2	0-255	Red dimmer 0-100%
3	0-255	Green dimmer 0-100%
4	0-255	Blue dimmer 0-100%
5	0-255	White dimmer 0-100%
6	0-14	Dimmer
6	15-255	Strobe speed
7	0-31	Invalid
7	32-63	From dark to light
7	64-95	From light to dark
7	96-127	Dark - light - dark
7	128-159	RGB degraded
7	160-191	Dark - light - automatic dark
7	192-223	4 color changes
7	224-255	Many color changes effects
8	0-255	Speed adjustment for channel 7

5. EXPLODED VIEW

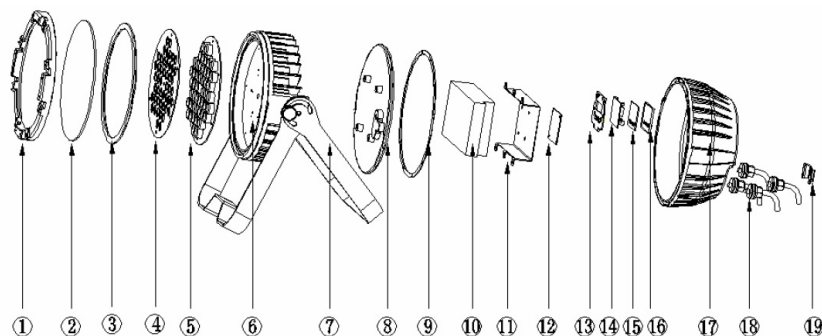

N°	Item	Quantity	N°	Item	Quantity
1	Front cover	1	6	Bulb holder	1
2	Glass	1	7	Bracket	1 set, 2 pcs
3	Glass waterproof silicone	1	8	Bottom case cover	1
4	Lens plate	1	9	Bottom case waterproof silicone	1
5	Lamp panel	1	10	Power supply	1

N°	Item	Quantity	N°	Item	Quantity
11	Power main board bracket	1	16	Waterproof silicone	1
12	Main board	1	17	Bottom base	1
13	Display platen	1	18	Wire clip	1
14	Display	1	19	Bumper bracket	1
15	Silica gel tableting	1			

6. OPERATION INSTRUCTIONS

Control panel

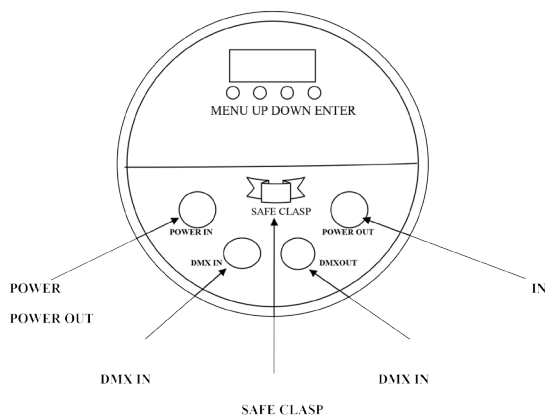

MENU : To access to the menu or return to a previous option

**UP
DOWN**

ENTER : Select an option

Menu

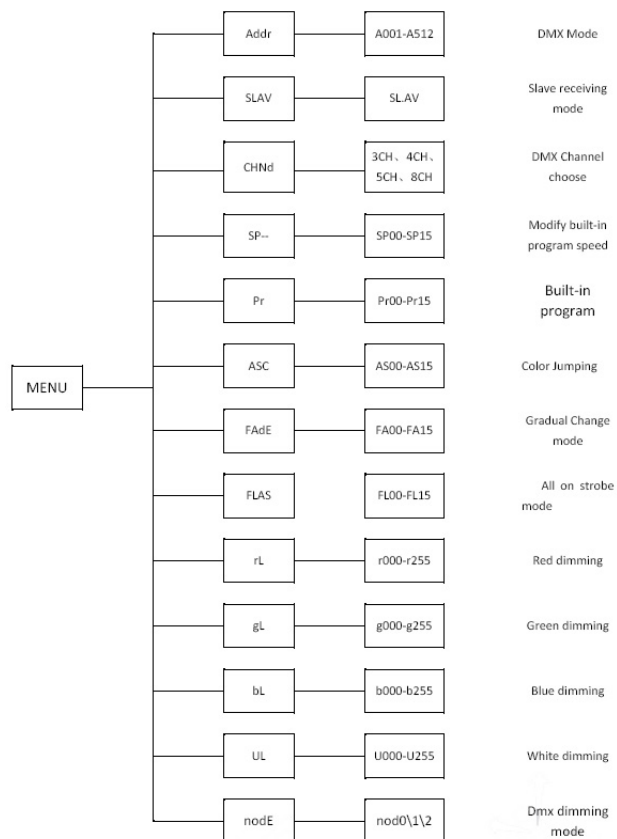

MENU is used to access to the menu or return to a previous option. It can not be used to select an option or save. Press UP / DOWN to select the desired menu. Details below :

- addr : DMX mode (A001-A512)
- SLAV : Slave mode
- CHNd : DMX channel (3-4-5-8 channel)
- SP : Integrated program for speed adjustment (SP00-SP15; SP00 the fastest)
- Pr : Integrated program (Pr00-Pr15; 16 programs in total)
- ASC : Several color changes (AS00-AS15 adjustable speed)
- FAde : FA00-FA15
- FLAS : White strobe (FL00-FL15 adjustable speed)
- rL : Red gradation (r000-r255; r255 the brightest)
- gL : Green gradation (g000-g255; g255 the brightest)
- bL : Blue gradation (b000-b255; b255 the brightest)
- UL : White gradation (U000-U255; U255 the brightest)

7. MASTER / SLAVE MODE

MASTER : The Master must always operate in Master and send a synchronization signal. It can not be configured in the DMX mode (addr), Slave (SLAV), channel DMX (CHNd) and nodE mode.

SLAVE : The projectors in Slave must be configured in the DMX mode.

8. SIGNAL CABLE CONNECTION

Connecting the signal cable : Connect the male plug with the female plug as below :

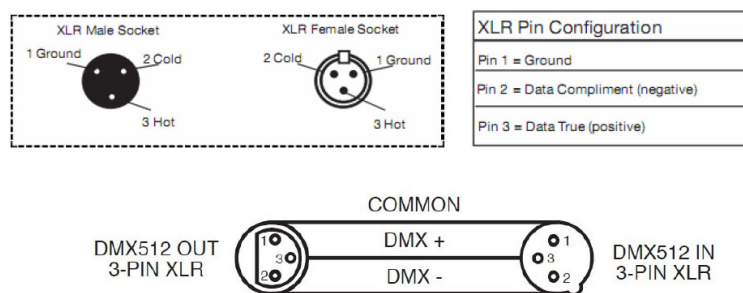

Note : To avoid signal transmission fault and interference, put a 120ohm (1/4W) resistance at the terminal of cable connection as below :



3 pin connector and 5 pin connector transfer : If your DMX 512 controller is of 5-pin connector, please use a signal cable that transfer 5-pin into 3-pin.

LINEARLEDS



Linear Technologie • 11 rue du Puits Rochefort • 42 100 Saint-Etienne
Tél: +33 (0)4 77 81 49 49 • Fax: +33 (0)4 77 81 49 40 • www.lineartech.fr